



Queens Drive, London, N4 2HW

Asking Price: £575,000 Share of
Freehold

2 Bedrooms | 1 Reception | 1 Bathroom

This two bedroom property offers 590 sq ft of living space. Accessible, affordable, and charming, boasting a homely and inviting atmosphere.

- Share of Freehold, s/c £915pa, g/r n/a
- Wonderful rear garden (over 35ft)
- Quiet ad peaceful location, close to Clissold Park and Finsbury Park (Victoria, Piccadilly & Overground)



Flat 1, 80 Queens Drive, London, N4 2HW

Introducing a charming and inviting ground floor apartment nestled in a modern town setting. This delightful property spans across 590 sq ft, boasting two well-appointed bedrooms, this apartment is perfect for individuals or small families seeking convenience and tranquility.

The property features a well-maintained garden, allowing residents to enjoy some outdoor



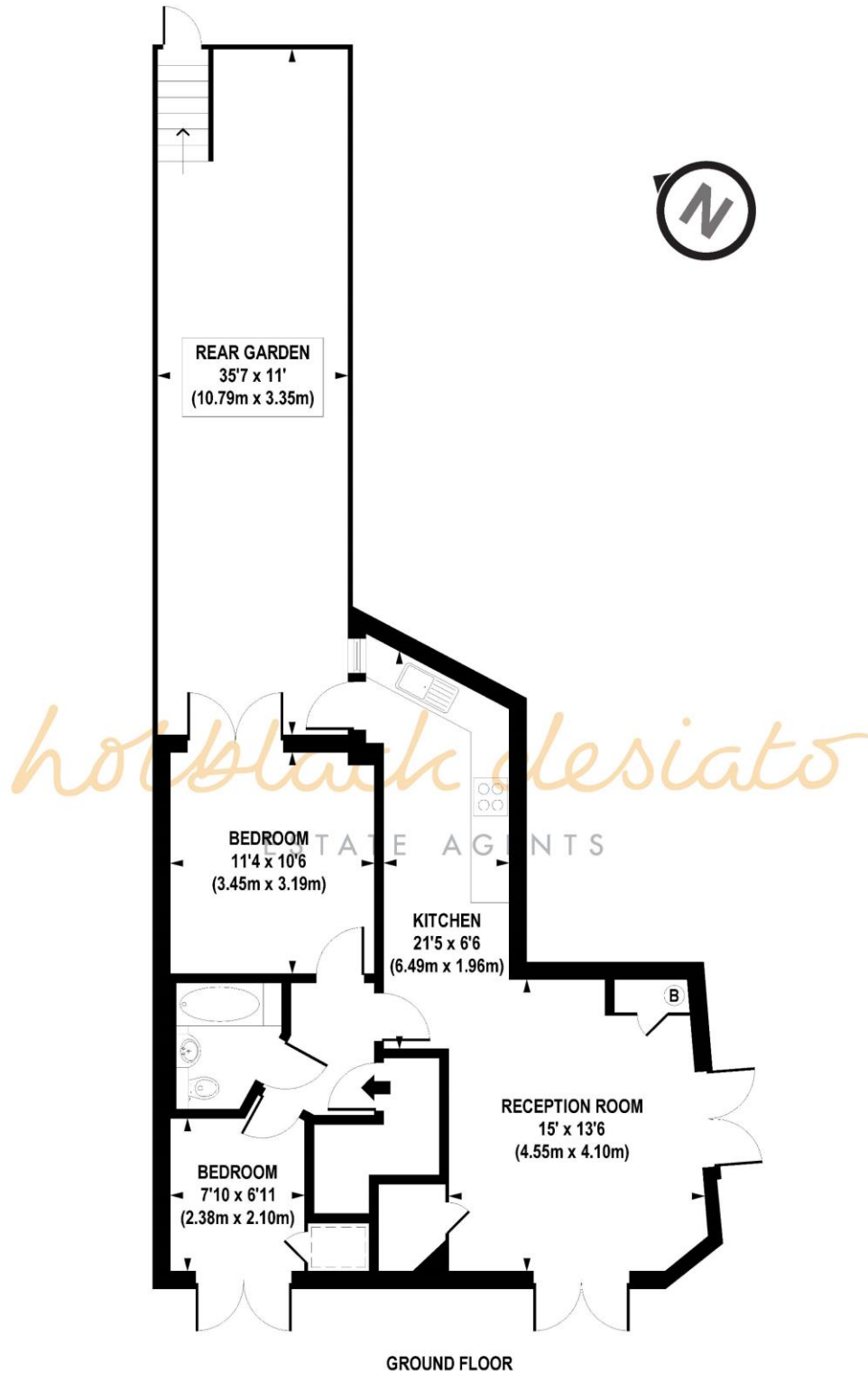

APPROX. GROSS INTERNAL FLOOR AREA 590 sq. ft / 54.84 sq. m

Floorplan is for illustrative purposes only and is not to scale.
Every attempt has been made to ensure the accuracy of the floorplan shown, however all measurements, fixtures, fittings and data shown are an approximate interpretation for illustrative purposes only.
Liability for errors, omissions or mis-statement through negligence or otherwise is hereby excluded.

Whilst every attempt has been made to ensure the accuracy of the floor plans contained here, measurements of doors, windows and rooms are approximate and no responsibility is taken for any error, omission or mis-statement. These plans are for representation purposes only as defined by RICS Code of Measuring Practice and should be used as such by any prospective purchaser. The services, systems and appliances listed in this specification have not been tested and no guarantee as to their operating ability or their efficiency can be given.

