



## Poets Road, London, N5 2SL

Asking Price: £535,000 Leasehold

**1 Total Bedroom | 1 Reception Room | 1 Bathroom**

Oozing period features, a raised ground floor flat with high ceilings, sash windows and well-presented throughout.

This one bedroom dwelling is comprised of a good sized reception/ dining room to the front, double bedroom, kitchen and bathroom toward the rear of the property.

- Leasehold 103 years
- Service charges: £900pa
- Ground rent: £10pa
- EPC - D



## 22b Poets Road, London, N5 2SL



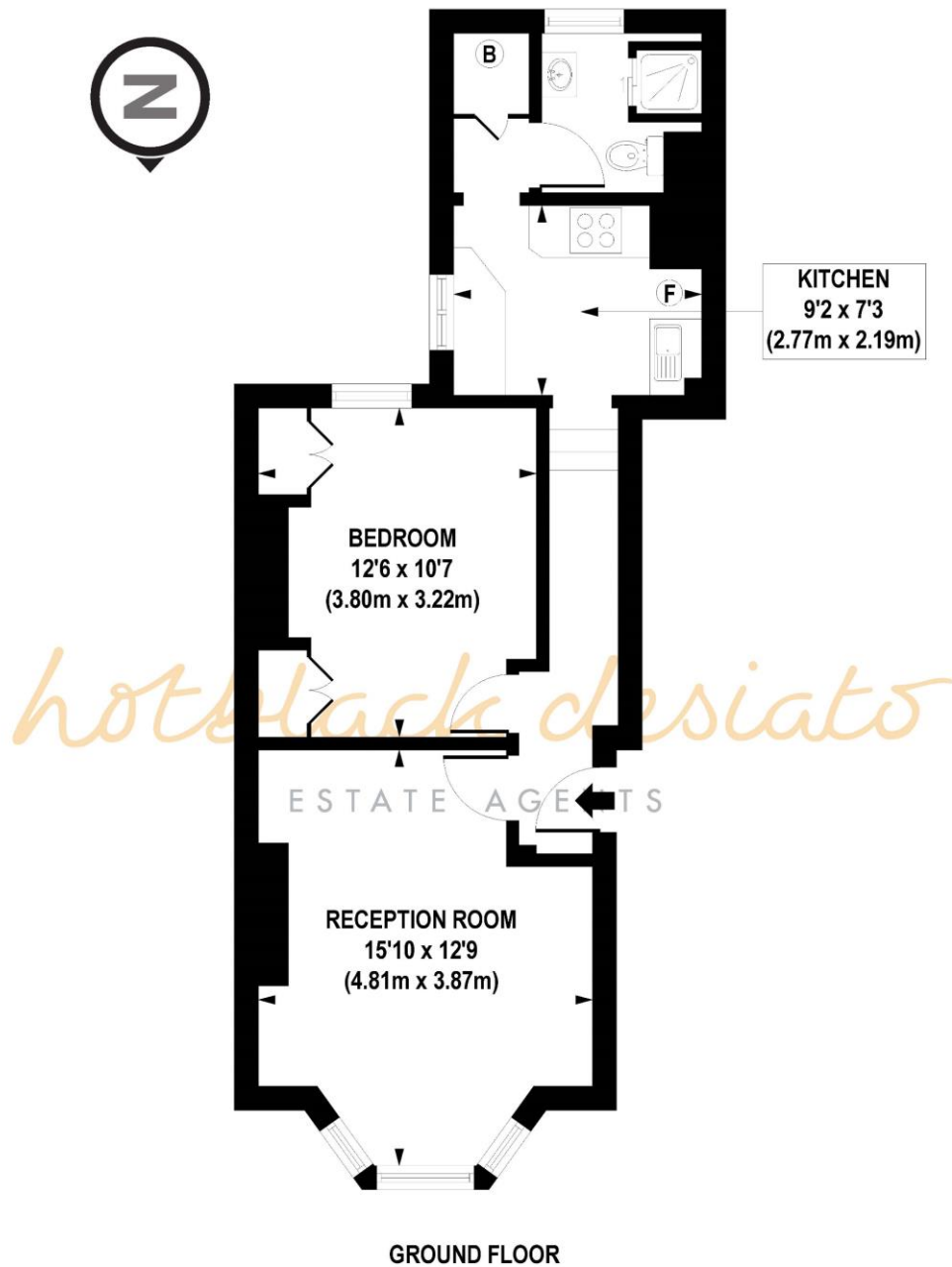

**APPROX. GROSS INTERNAL AREA FLOOR 489 sq. ft / 45.41 sq. m**

Floorplan is for illustrative purposes only and is not to scale.  
Every attempt has been made to ensure the accuracy of the floorplan shown, however all measurements, fixtures, fittings and data shown are an approximate interpretation for illustrative purposes only.  
Liability for errors, omissions or mis-statement through negligence or otherwise is hereby excluded.

Whilst every attempt has been made to ensure the accuracy of the floor plans contained here, measurements of doors, windows and rooms are approximate and no responsibility is taken for any error, omission or mis-statement. These plans are for representation purposes only as defined by RICS Code of Measuring Practice and should be used as such by any prospective purchaser. The services, systems and appliances listed in this specification have not been tested and no guarantee as to their operating ability or their efficiency can be given.

