



138, Highbury Quadrant, London, N5 2TZ

Asking Price: £500,000 Leasehold

**2 Total Bedrooms | 1 Reception Rooms | 1
Bathrooms**

A well presented and modernized two bedroom apartment within a small building in the heart of leafy Highbury. Recently refurbished to a high standard, the flat is situated on the second floor and offers a generous living space, refurbished bathroom, two good sized bedrooms, ample storage and a south facing balcony. part furnished and available 3rd October.

- Leasehold
- 2 Total Bedrooms
- 1 Reception Rooms
- 1 Bathrooms
- Flat/Apartment
- Upper Floor
- Balcony
- Modern
- Town/City
- Very Good decoration
- 659 Approx Sq Ft



138, Highbury Quadrant, London, N5 2TZ



www.steele.london www.steele.london

Photography, Floorplans, Virtual Tours & EPC

www.steele.london www.steele.london

Photography, Floorplans, Virtual Tours & EPC

www.steele.london www.steele.london

Photography, Floorplans, Virtual Tours & EPC

www.steele.london www.steele.london

Photography, Floorplans, Virtual Tours & EPC

www.steele.london www.steele.london

Photography, Floorplans, Virtual Tours & EPC

www.steele.london www.steele.london

Photography, Floorplans, Virtual Tours & EPC

www.steele.london www.steele.london

Photography, Floorplans, Virtual Tours & EPC

www.steele.london www.steele.london

Photography, Floorplans, Virtual Tours & EPC

www.steele.london www.steele.london

Photography, Floorplans, Virtual Tours & EPC

www.steele.london www.steele.london

Photography, Floorplans, Virtual Tours & EPC

www.steele.london www.steele.london

Photography, Floorplans, Virtual Tours & EPC

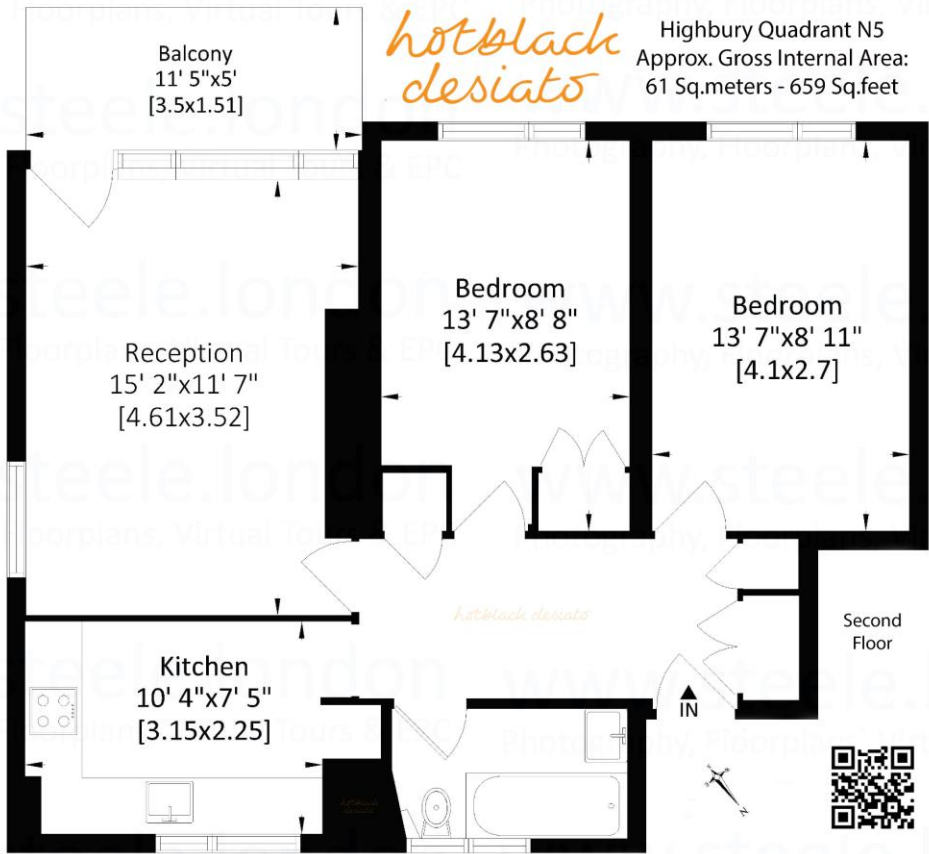

hotblack
desiato

Highbury Quadrant N5
Approx. Gross Internal Area:
61 Sq.meters - 659 Sq.feet

Prepared for Hotblack Estate Agents www.hotblackdesiato.co.uk. Whilst every attempt has been made to ensure the accuracy of this Lettings floor plan measurements of doors, windows, rooms & Sq.footage are approximate. For identification Purposes only. The actual property will vary. Price on application for a 90 day Licence to use this Plan ©07082022. Not to scale. Photography, Floorplan, Virtual Tours, Inventory, Video & EPC's by www.steele.london email. patricia@steele.london Tel. 07847219401

Whilst every attempt has been made to ensure the accuracy of the floor plans contained here, measurements of doors, windows and rooms are approximate and no responsibility is taken for any error, omission or mis-statement. These plans are for representation purposes only as defined by RIICS Code of Measuring Practice and should be used as such by any prospective purchaser. The services, systems and appliances listed in this specification have not been tested and no guarantee as to their operating ability or their efficiency can be given.

