



Highbury Hill, Highbury, London, N5 1AL

Asking Price: £575,000 Leasehold

1 Bedroom | 1 Reception Room | 1 Bathroom

A delightful one double bedroom flat in a very attractive late Victorian conversion on a prestigious street in the heart of Highbury.

- Leasehold 103 years 11 months
- Service charge £1,600 pa
- Ground rent £200 pa



Highbury Hill, Highbury, London, N5 1AL

The property has been recently and tastefully decorated and offers a large double bedroom, clean and bright bathroom suite, spacious and light reception with feature fireplace and large windows leading to an open-plan fully fitted kitchen 'eat in' kitchen.



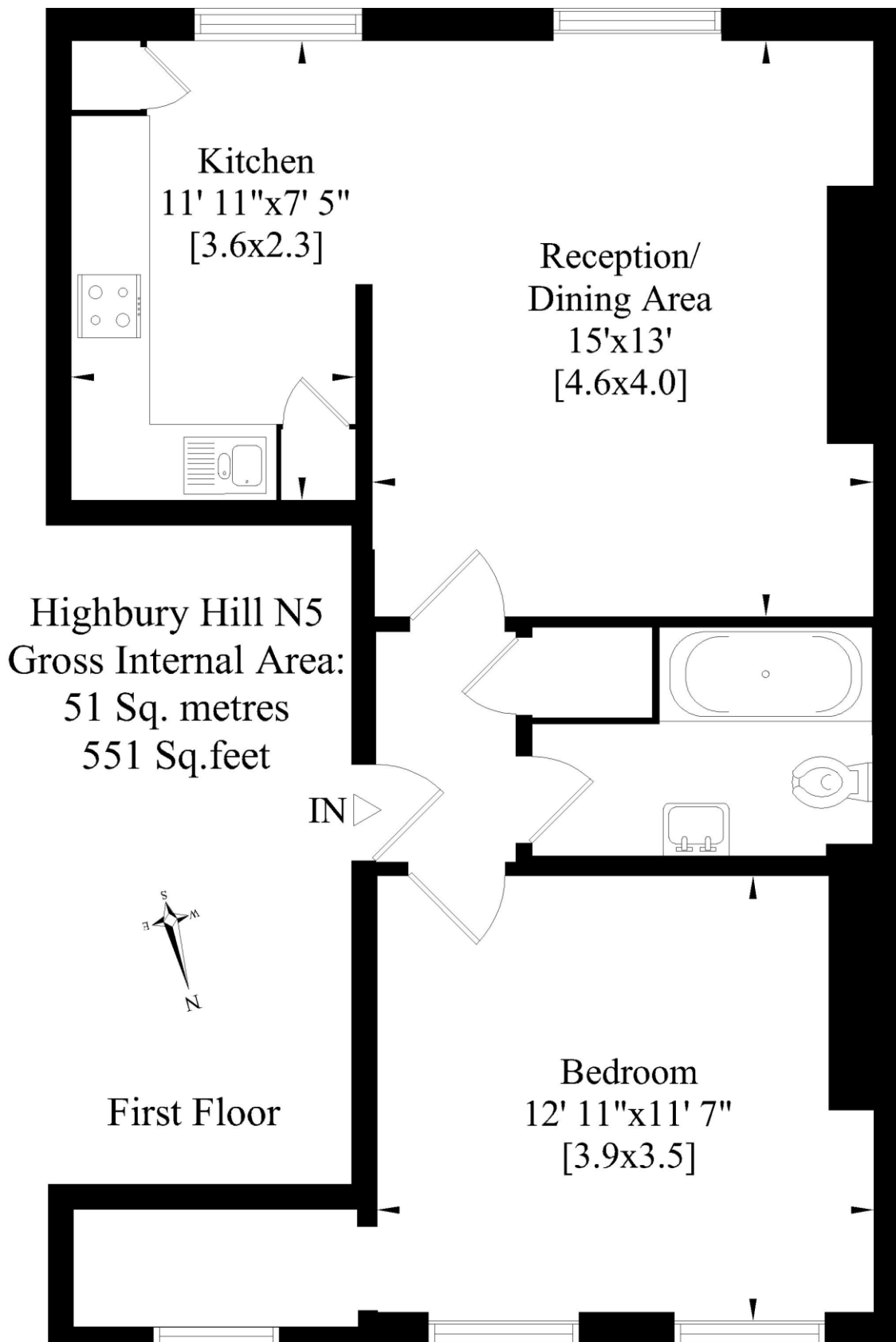

Whilst every attempt has been made to ensure the accuracy of this floor plan, measurements of doors, windows and rooms are approximate. For identification purposes only. Not to scale.©

Whilst every attempt has been made to ensure the accuracy of the floor plans contained here, measurements of doors, windows and rooms are approximate and no responsibility is taken for any error, omission or mis-statement. These plans are for representation purposes only as defined by RICS Code of Measuring Practice and should be used as such by any prospective purchaser. The services, systems and appliances listed in this specification have not been tested and no guarantee as to their operating ability or their efficiency can be given.

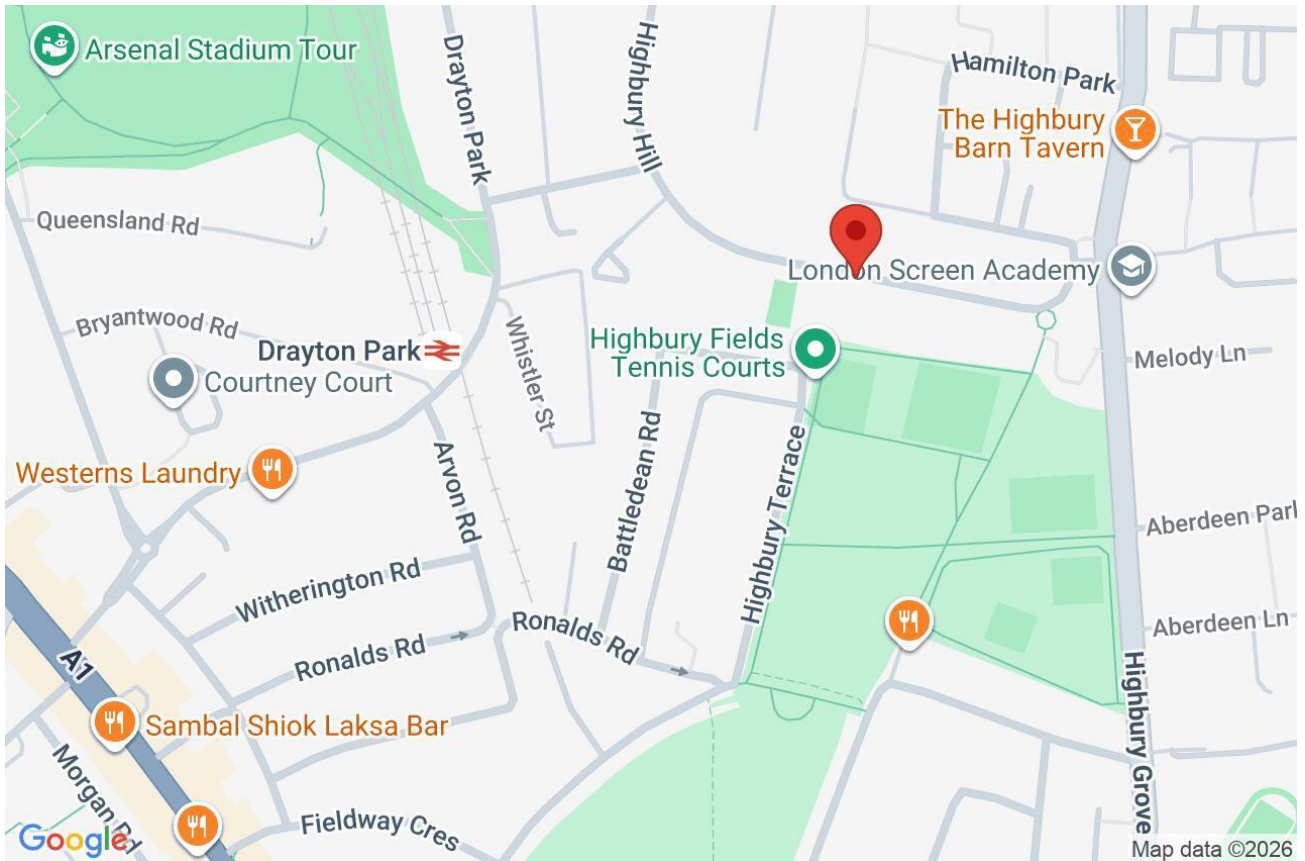

Energy Efficiency Rating		Current	Potential
Very energy efficient - lower running costs			
(92+)	A		
(81-91)	B		
(69-80)	C		80
(55-68)	D	65	
(39-54)	E		
(21-38)	F		
(1-20)	G		
Not energy efficient - higher running costs			
England, Scotland & Wales		EU Directive 2002/91/EC	