



## Stroud Green Road, London, N4 3EF

Asking Price: £415,000 Leasehold

**2 Bedrooms | 1 Reception Room | 1 Bathroom**

Charming 2-bed period first-floor apartment in a sought-after location. This cosy property boasts resident parking and is perfect for those seeking a peaceful retreat in the heart of the city. Don't miss out on this gem!

- Leasehold 992 years 10 months
- First Floor
- Service charge £500 pa



## Stroud Green Road, London, N4 3EF

Introducing this charming and cosy period first floor apartment, located in a sought-after area. This delightful property boasts two bedrooms, perfect for a small family or professionals looking for a comfortable living space. The apartment features a well-designed layout with a spacious living area, a modern kitchen equipped with essential appliances, and a stylish bathroom. Residents can benefit from convenient resident parking, ensuring hassle-free access to their home.



# Stroud Green Road, N4

○ - Ceiling Height

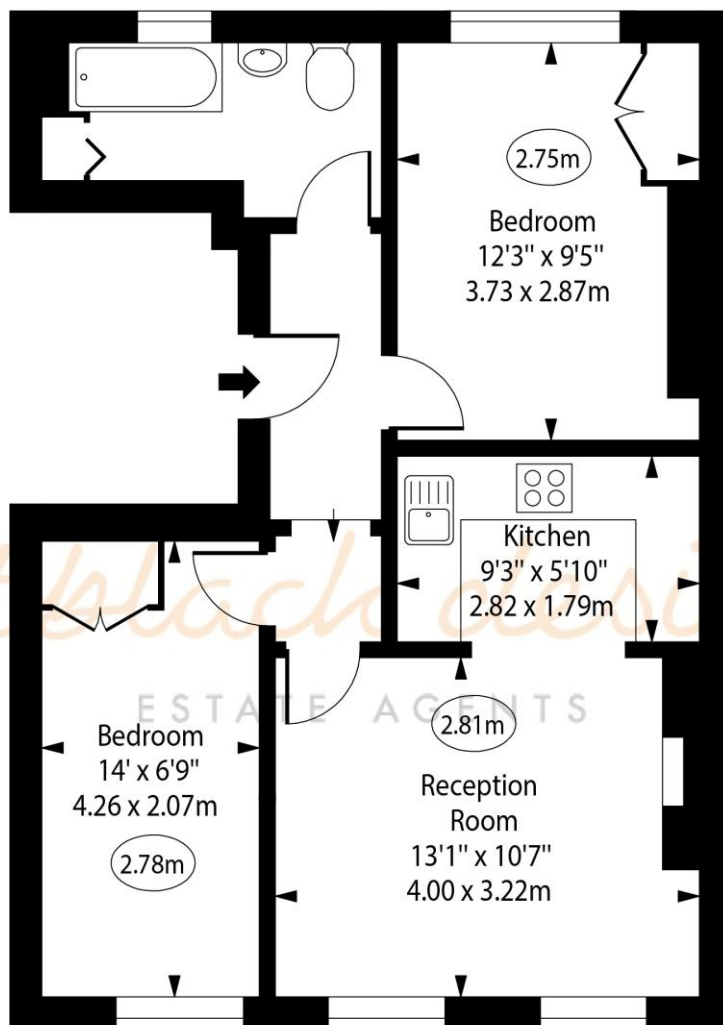

First Floor

Approx Gross Internal Area      523 Sq Ft - 48.59 Sq M

Every attempt has been made to ensure the accuracy of the floor plan shown. However, all measurements, fixtures, fittings, and data shown are approximate interpretations and for illustrative purposes only. Measured according to the RICS. Not To Scale.

[www.goldlens.co.uk](http://www.goldlens.co.uk)

Ref. No. 030633J

Whilst every attempt has been made to ensure the accuracy of the floor plans contained here, measurements of doors, windows and rooms are approximate and no responsibility is taken for any error, omission or mis-statement. These plans are for representation purposes only as defined by RICS Code of Measuring Practice and should be used as such by any prospective purchaser. The services, systems and appliances listed in this specification have not been tested and no guarantee as to their operating ability or their efficiency can be given.

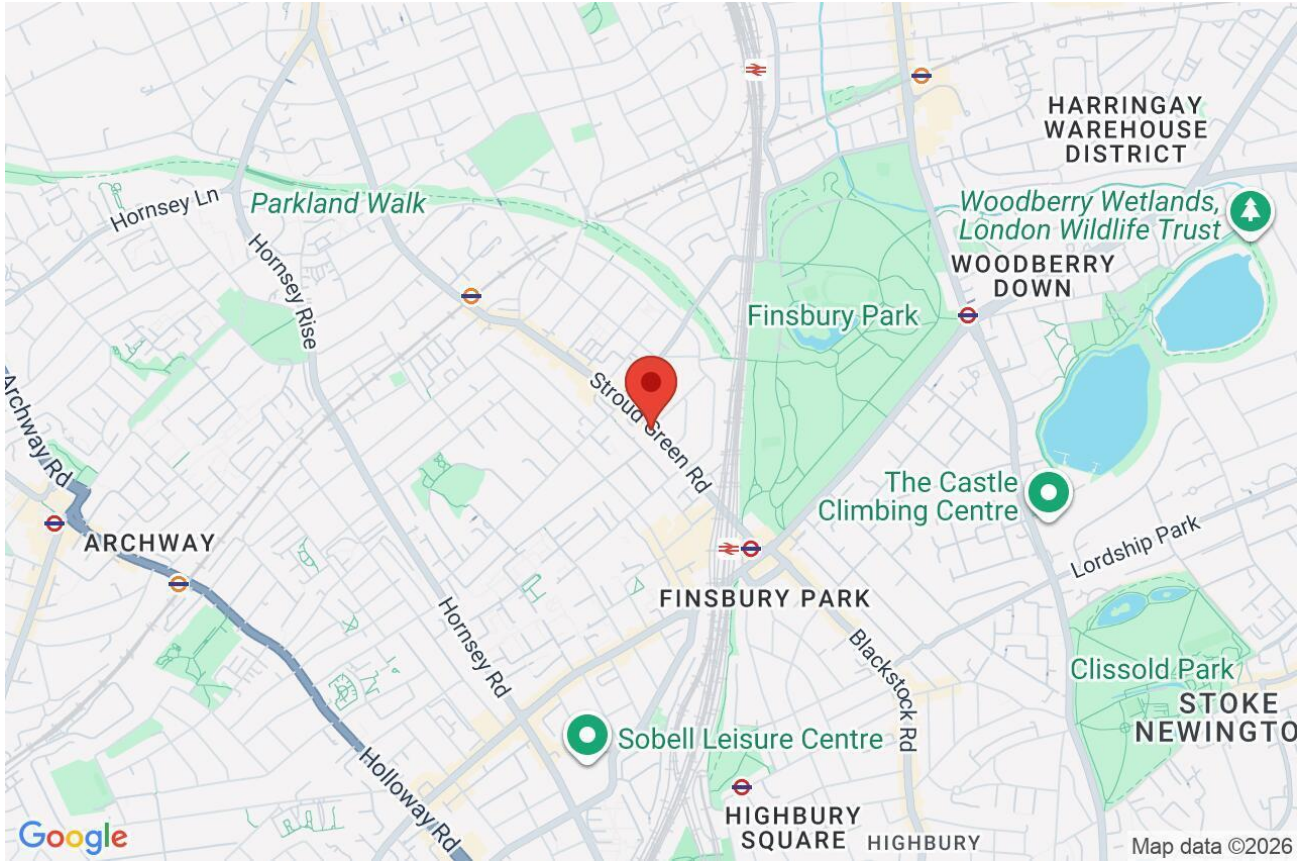

Score	Energy rating	Current	Potential
92+	A		
81-91	B		
69-80	C		75 C
55-68	D	66 D	
39-54	E		
21-38	F		
1-20	G		