



Burton Bank, Yeate Street, London, N1 3EP

Asking Price: £375,000 Share of
Freehold

**1 Total Bedroom | 1 Reception Room | 1
Bathroom**

A well-presented ground floor flat in the sought-after Day Block, offering a share of freehold and direct views over beautifully maintained communal gardens in the heart of Islington.

- Share of Freehold 999 years
- Chain Free
- A well-presented ground floor flat in the sought-after day block
- Direct views over beautifully maintained communal gardens
- In the heart of Islington



Burton Bank, Yeate Street, London, N1 3EP

Burton Bank is exceptionally well connected, with a variety of nearby transport options. Essex Road Station is just a 7-minute walk away, while Haggerston and Canonbury Overground stations are also within easy reach. For further connections, Highbury & Islington Station serving the Victoria Line, Overground, and National Rail is less than a mile away, offering swift access to central London and beyond.



Burton Bank,
Yeate Street, N1

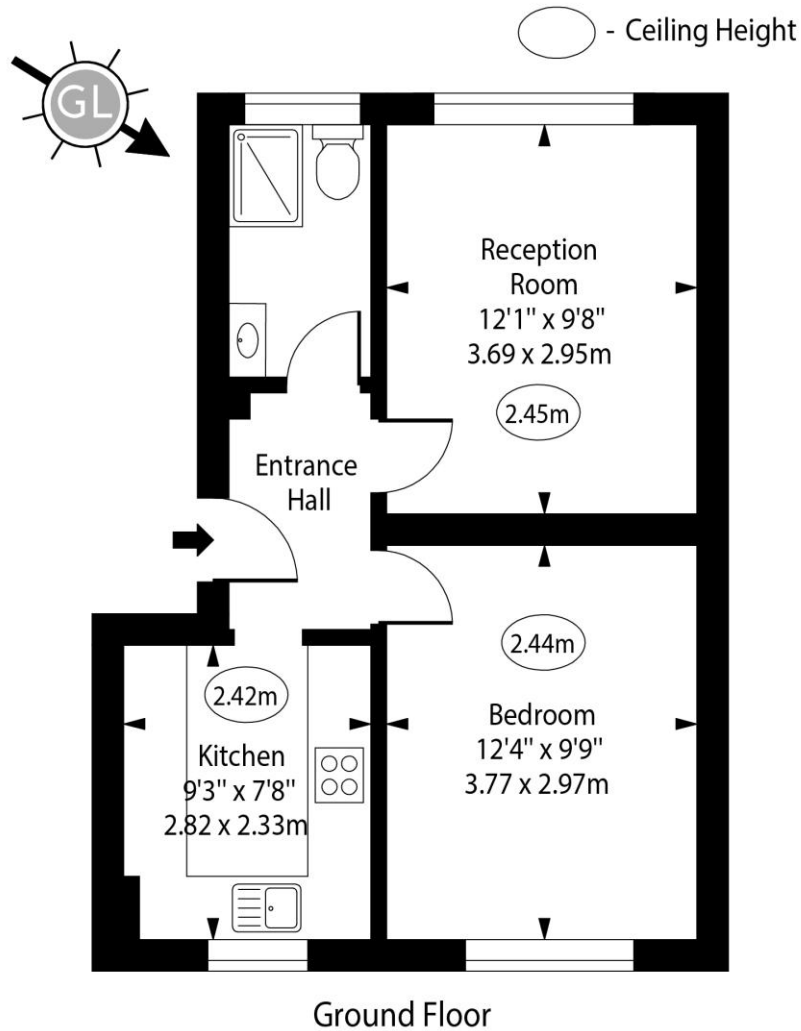

Approx Gross Internal Area 400 Sq Ft - 37.16 Sq M

Every attempt has been made to ensure the accuracy of the floor plan shown.
However, all measurements, fixtures, fittings, and data shown are approximate interpretations and
for illustrative purposes only. Measured according to the RICS. Not To Scale.

www.goldlens.co.uk

Ref. No. 029412J

Whilst every attempt has been made to ensure the accuracy of the floor plans contained here, measurements of doors, windows and rooms are approximate and no responsibility is taken for any error, omission or mis-statement. These plans are for representation purposes only as defined by RICS Code of Measuring Practice and should be used as such by any prospective purchaser. The services, systems and appliances listed in this specification have not been tested and no guarantee as to their operating ability or their efficiency can be given.

