



Belmont Court, 93 Highbury New Park, London, N5 2HA

Asking Price: £735,000 Share of Freehold

2 Bedrooms | 1 Reception Room | 1 Bathroom

A very well presented two bedroom second floor flat with roof terrace.

- Share of Freehold 992 years
- Service charge: £3522pa
- Ground rent: n/a
- Council tax: Band D



38 Belmont Court, 93 Highbury New Park, London, N5 2HA

This apartment is located in a very popular block on Highbury New Park. It is light, airy and has the added benefit of a roof terrace. The outlook from the flat is particularly pleasant, with views over leafy tree tops and the wide tree-lined grandeur of Highbury New Park.



Belmont Court, N5

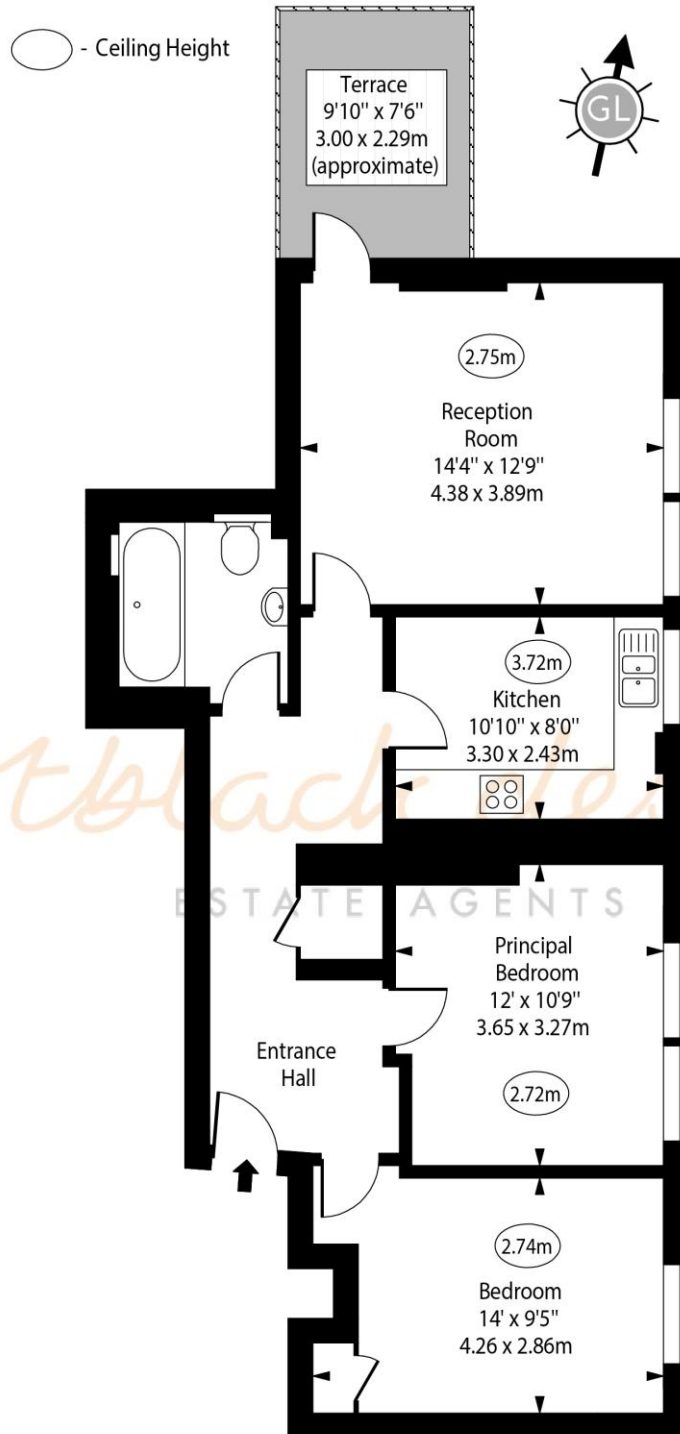

Second Floor

Approx Gross Internal Area

750 Sq Ft - 69.68 Sq M

Every attempt has been made to ensure the accuracy of the floor plan shown. However, all measurements, fixtures, fittings, and data shown are approximate interpretations and for illustrative purposes only. Measured according to the RICS. Not To Scale.

www.goldlens.co.uk

Ref. No. 029290R

Whilst every attempt has been made to ensure the accuracy of the floor plans contained here, measurements of doors, windows and rooms are approximate and no responsibility is taken for any error, omission or mis-statement. These plans are for representation purposes only as defined by RICS Code of Measuring Practice and should be used as such by any prospective purchaser. The services, systems and appliances listed in this specification have not been tested and no guarantee as to their operating ability or their efficiency can be given.

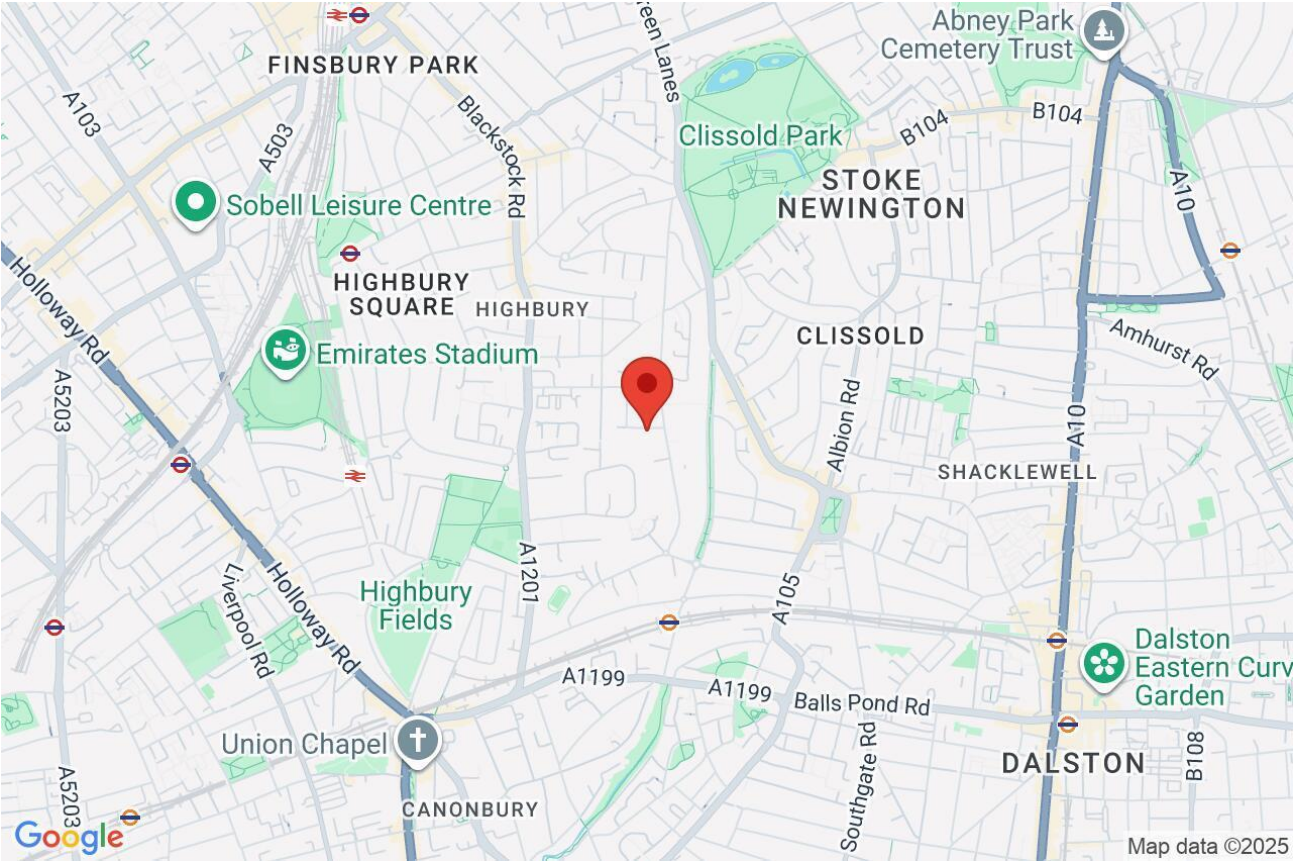

Score	Energy rating	Current	Potential
92+	A		
81-91	B		
69-80	C		81 B
55-68	D	68 D	
39-54	E		
21-38	F		
1-20	G		