



Flat 10, 489 Holloway Road, London, N19 4DD

Asking Price: £210,000 Leasehold

This well presented studio apartment within a period house, located moments from the open spaces of Whittington Park and within short walking distance of both Upper Holloway Overground Station and Archway Underground Station.

- Leasehold 997 years
- Chain Free
- Second floor
- Period
- Upper Floor
- Studio apartment
- Good decoration
- 198 Approx Sq Ft



Flat 10, 489 Holloway Road, London, N19 4DD



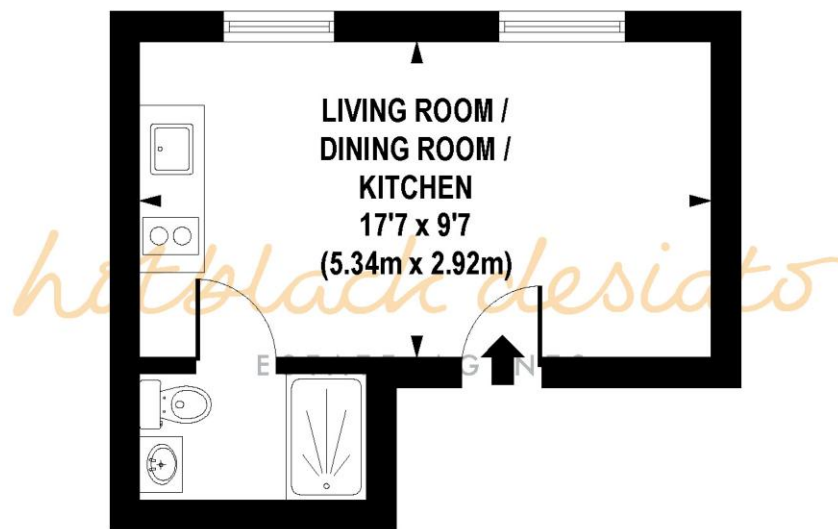

SECOND FLOOR

APPROX. GROSS INTERNAL FLOOR AREA 198 sq. ft / 18.39 sq. m

Floorplan is for illustrative purposes only and is not to scale.
Every attempt has been made to ensure the accuracy of the floorplan shown, however all measurements, fixtures, fittings and data shown are an approximate interpretation for illustrative purposes only.
Liability for errors, omissions or mis-statement through negligence or otherwise is hereby excluded.

Whilst every attempt has been made to ensure the accuracy of the floor plans contained here, measurements of doors, windows and rooms are approximate and no responsibility is taken for any error, omission or mis-statement. These plans are for representation purposes only as defined by RICS Code of Measuring Practice and should be used as such by any prospective purchaser. The services, systems and appliances listed in this specification have not been tested and no guarantee as to their operating ability or their efficiency can be given.

