



Pyrland Road, London, N5 2JB

Asking Price: £2,250,000 Freehold

5 Total Bedrooms

A beautifully proportioned Victorian family home spanning over 2,100 sq ft, full of period character along with a landscaped south-facing garden. Set on Pyrland Road, a quiet tree-lined street in the heart of Highbury, moments from Highbury Fields, Clissold Park and the vibrant cafés and shops of Newington Green.

- A beautiful Victorian family home with abundant period features throughout
- Large South-facing Garden
- Five generous double bedrooms plus a versatile lower ground floor space
- Nestled on a quiet, tree-lined street in the heart of Highbury



Pyrland Road, London, N5 2JB

Set on Pyrland Road, a quiet tree-lined street in the heart of Highbury, this impressive Victorian family home combines generous proportions with timeless character. Arranged across four floors and spanning approx. 2,100 sq ft, the property retains an abundance of period charm, with high ceilings, ornate cornicing, fireplaces and large sash windows flooding the rooms with natural light.



Pyrland Road, N5



○ - Ceiling Height

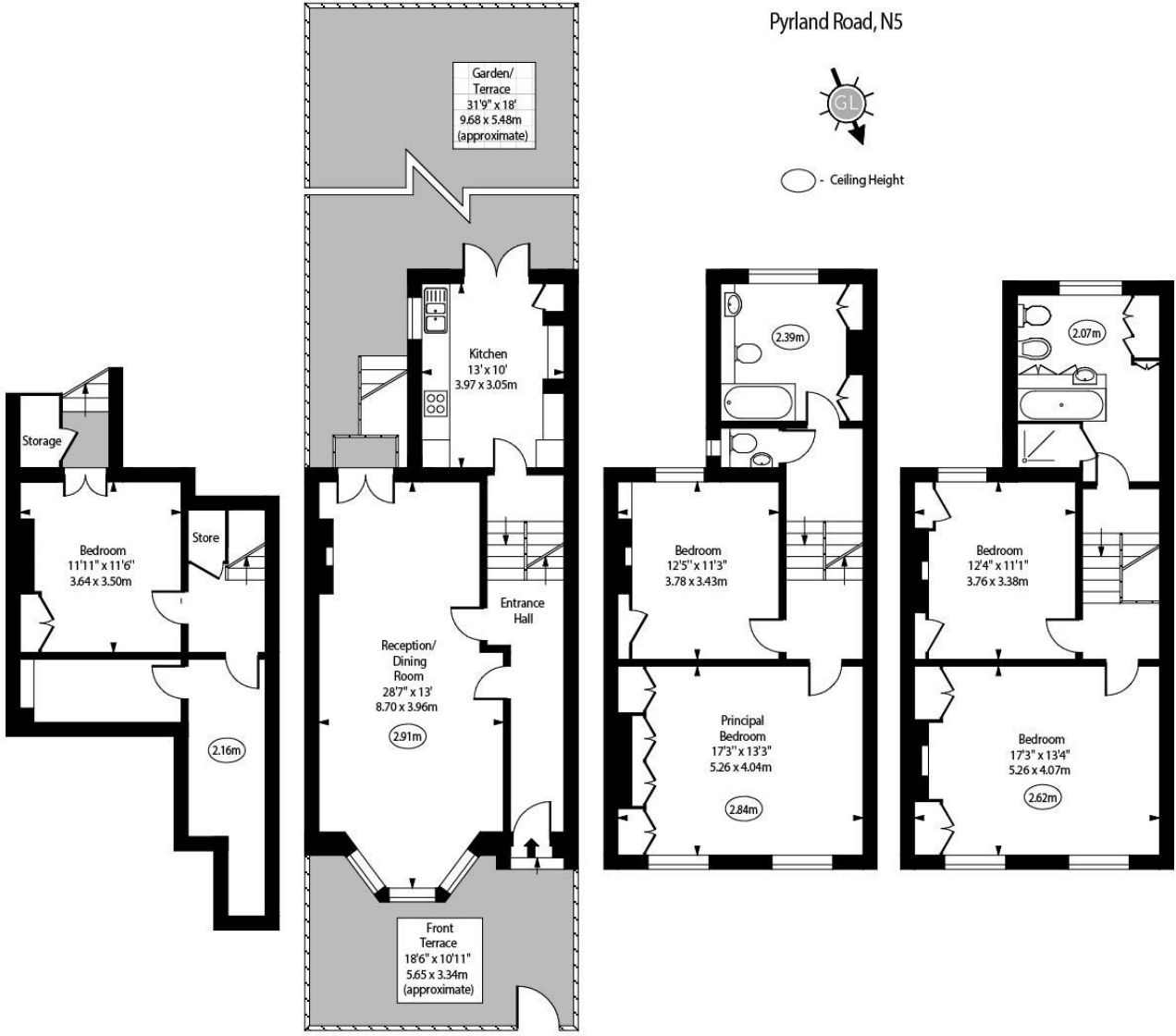

Basement

Ground Floor

First Floor

Second Floor

Approx Gross Internal Area 2100 Sq Ft - 195.09 Sq M

Every attempt has been made to ensure the accuracy of the floor plan shown. However, all measurements, fixtures, fittings, and data shown are approximate interpretations and for illustrative purposes only. Measured according to the RICS. Not To Scale.
www.goldlens.co.uk
 Ref. No. 028767D

Whilst every attempt has been made to ensure the accuracy of the floor plans contained here, measurements of doors, windows and rooms are approximate and no responsibility is taken for any error, omission or mis-statement. These plans are for representation purposes only as defined by RICS Code of Measuring Practice and should be used as such by any prospective purchaser. The services, systems and appliances listed in this specification have not been tested and no guarantee as to their operating ability or their efficiency can be given.

