



Gloucester Drive, London, N4 2LE

Offers Over: £315,000 Leasehold

1 Bedroom | 1 Reception Room | 1 Bathroom

Perched on the first floor of this Victorian conversion, a spacious apartment with roof terrace. Presented in immaculate condition in a peaceful location with excellent transport links, this property will make a fabulous first time purchase.

- Leasehold 132 years 9 months
- Ground rent £250 pa



Gloucester Drive, London, N4 2LE

Perched on the first floor of this Victorian conversion, a spacious apartment with roof terrace. Presented in immaculate condition in a peaceful location with excellent transport links, this property will make a fabulous first time purchase.



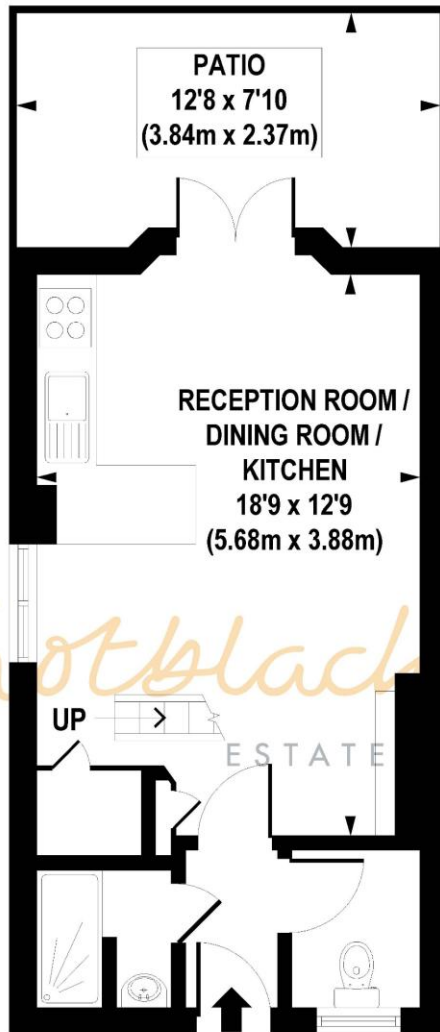

**GROUND FLOOR
GROSS INTERNAL
FLOOR AREA 314 SQ FT**

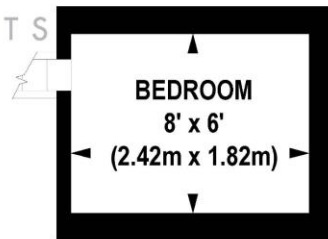

**MEZZANINE
GROSS INTERNAL
FLOOR AREA 47 SQ FT**

APPROX. GROSS INTERNAL FLOOR AREA 361 sq. ft / 33.54 sq. m

Floorplan is for illustrative purposes only and is not to scale.
Every attempt has been made to ensure the accuracy of the floorplan shown, however all measurements, fixtures, fittings and data shown are an approximate interpretation for illustrative purposes only.
Liability for errors, omissions or mis-statement through negligence or otherwise is hereby excluded.

CP CREATIVE
PROPERTY MARKETING

Whilst every attempt has been made to ensure the accuracy of the floor plans contained here, measurements of doors, windows and rooms are approximate and no responsibility is taken for any error, omission or mis-statement. These plans are for representation purposes only as defined by RICS Code of Measuring Practice and should be used as such by any prospective purchaser. The services, systems and appliances listed in this specification have not been tested and no guarantee as to their operating ability or their efficiency can be given.

