



Benwell Road, London, N7 7BW

Asking Price: £575,000 Leasehold

2 Bedrooms | 1 Reception Room | 1 Bathroom

A spacious and well presented garden flat is on the ground floor of a Victorian converted house located close to the amenities of Holloway Road and nearby Highbury.

- Well presented, ground floor garden flat near Highbury
- Great access to the City via Drayton Park - Moorgate in 10 minutes
- Good decor throughout, quiet street with many eateries and Waitrose in walking distance



Flat 2, 81 Benwell Road, London, N7 7BW



Benwell Road

Approximate Gross Internal Area = 616 sq ft / 57.2 sq m

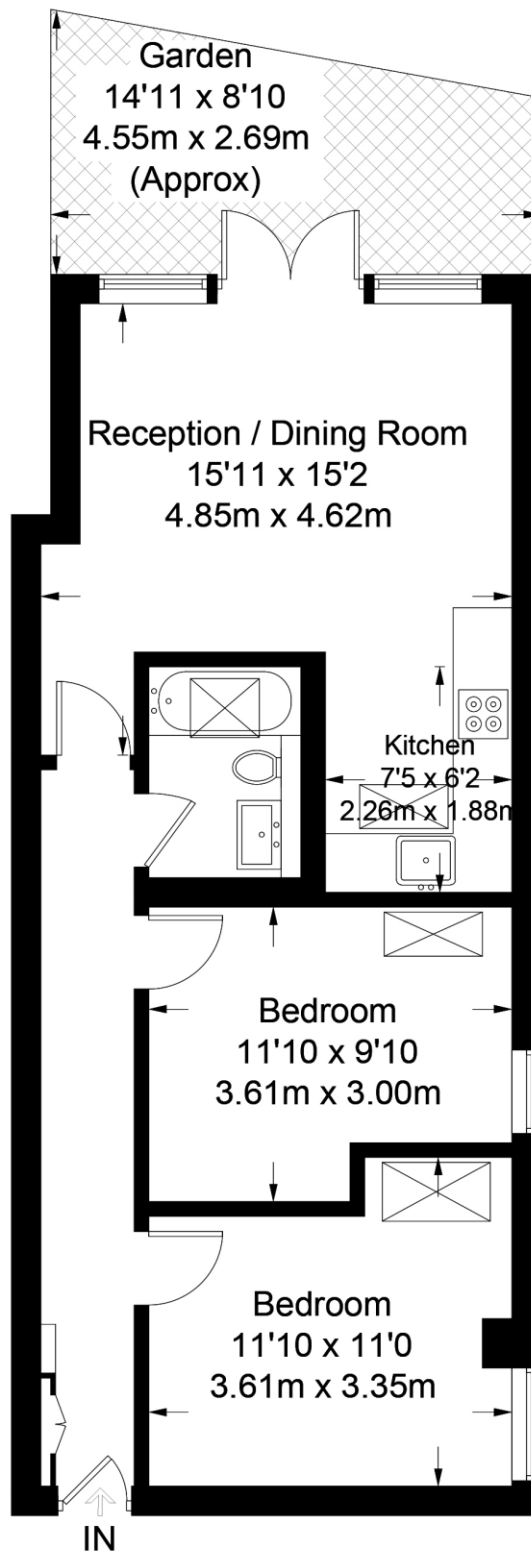

Ground Floor

Not to scale, for guidance only and must not be relied upon as a statement of fact.
All measurements and areas are approximate only and have been prepared in accordance with the current edition of the RICS Code of Measuring Practice.

Whilst every attempt has been made to ensure the accuracy of the floor plans contained here, measurements of doors, windows and rooms are approximate and no responsibility is taken for any error, omission or mis-statement. These plans are for representation purposes only as defined by RICS Code of Measuring Practice and should be used as such by any prospective purchaser. The services, systems and appliances listed in this specification have not been tested and no guarantee as to their operating ability or their efficiency can be given.

